

Bom MHTM™ MicroDrive

ACCESS

ACCESS PRO

ACCESS SELECT

PARKING

PARKING PRO

PARKING SELECT

Hurtiganvisning

ADVARSEL!

Denne manualen er en hurtiganvisning. Denne manualen erstatter ikke brukermanualen "MHTM™ MicroDrive" (Dok-ID: 5815,5001) som tilhører leveransen.

Denne hurtiganvisningen retter seg mot spesialister som allerede har erfaring med monteringen, installasjonen og igangsettingen.



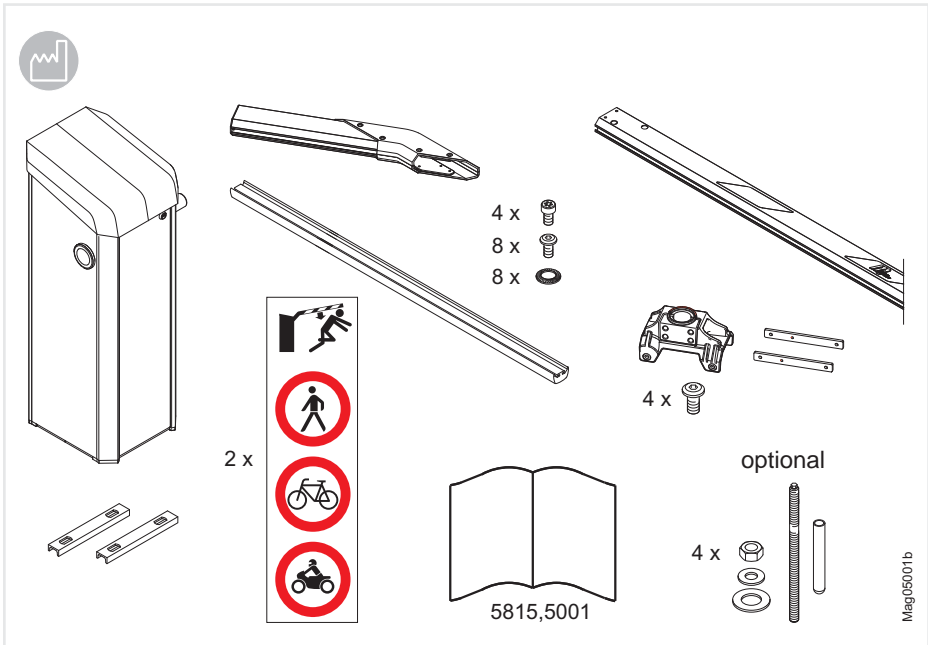

Utførlige informasjonen finner du i brukermanualen. Les nøye gjennom brukermanualen før utførelse av alle arbeider.

Forutsetning for sikkert arbeid er overholdelsen av alle sikkerhetsanvisningene som er angitt i brukermanualen.

Produsenten er ikke ansvarlig for skader, som oppstår grunnet ikke-forskriftsmessig eller ikke-bestemmelsesrett bruk.

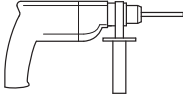
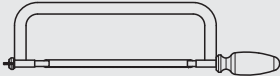
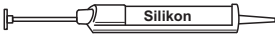
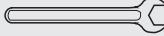

Hurtiganvisning

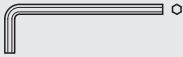
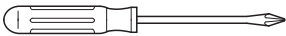
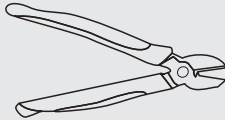
Nødvendig verktøy		
	Slagbormaskin	10 mm
	Sag	–
	Silikonpatron	–
	Fastnøkkel	13 mm
	Unbrakonøkkel	SW 5
	Unbrakonøkkel	SW 10
	Torx-nøkkel	T20
	Unbrakonøkkel	SW 4
	Stjerneskrutrekker	for 3,5 mm
	Sidekutter	–

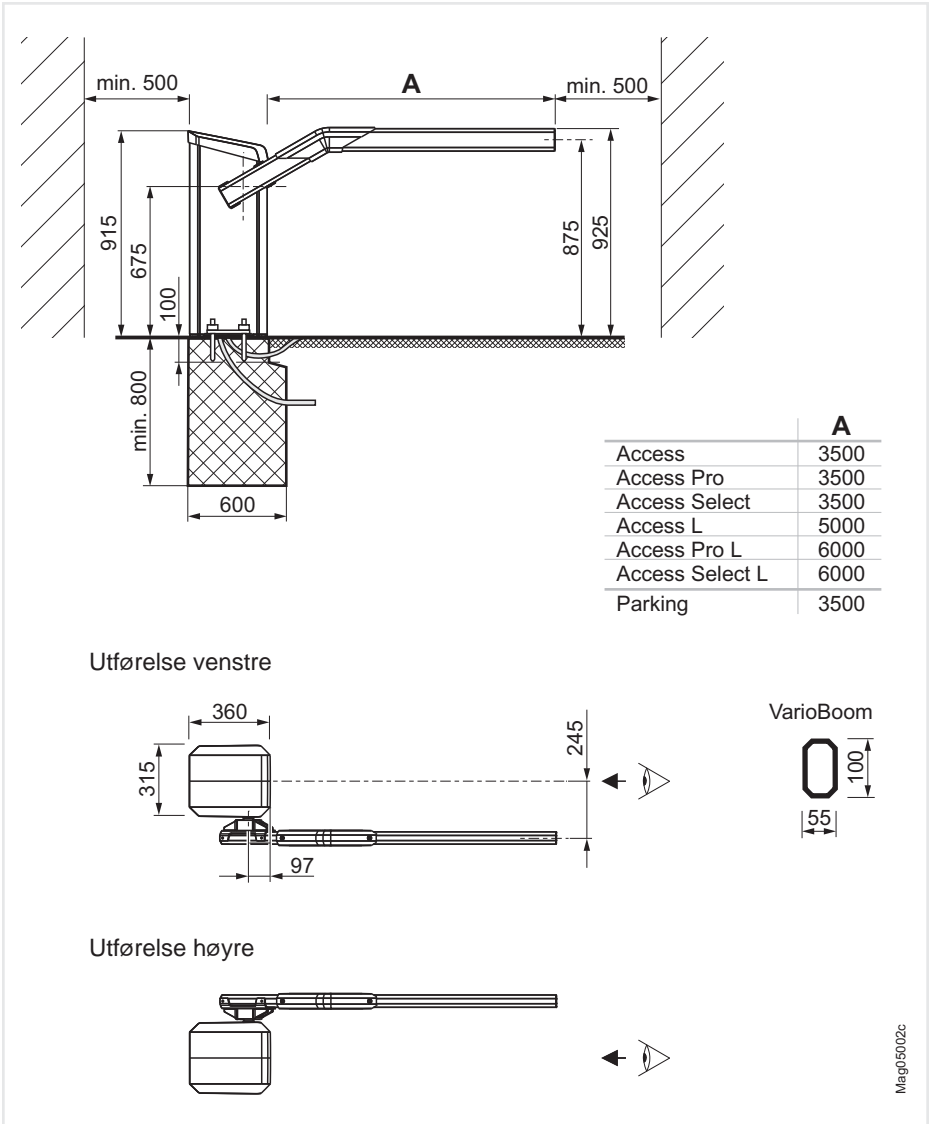

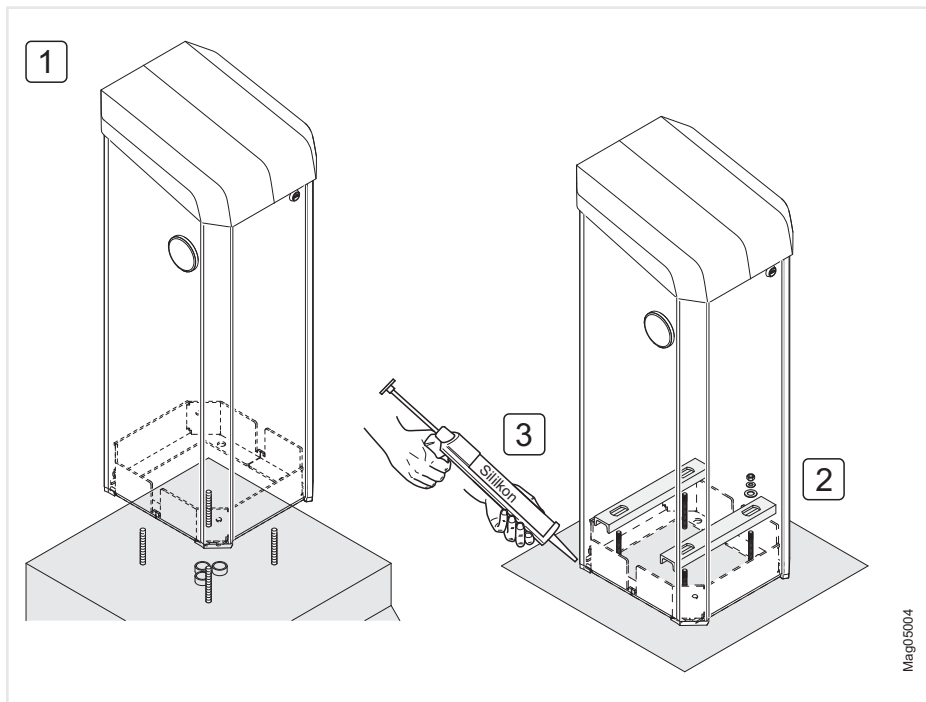
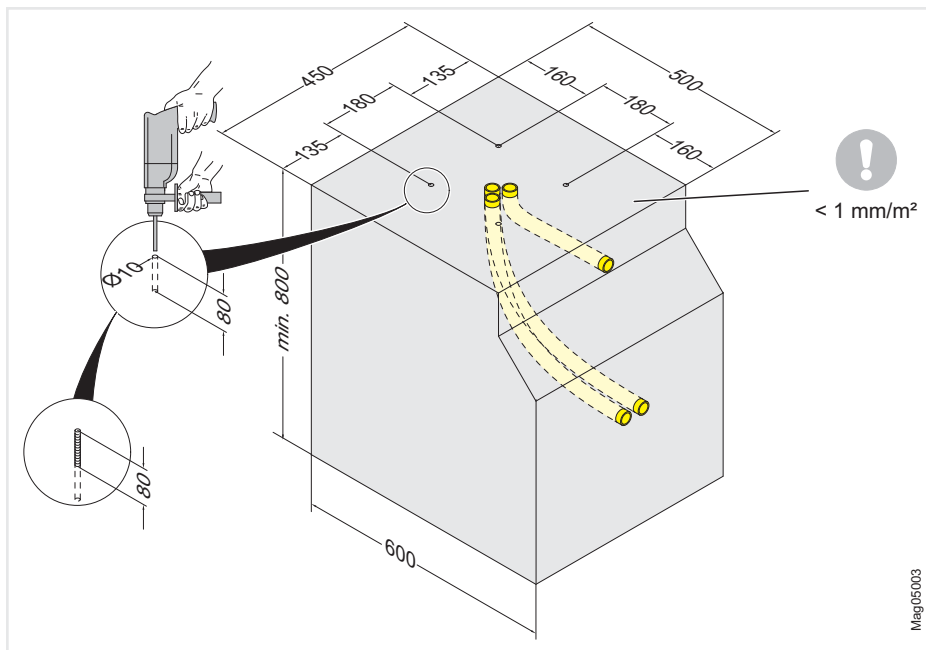



**Elektrisk
spenning!**

1

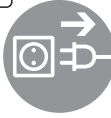

2

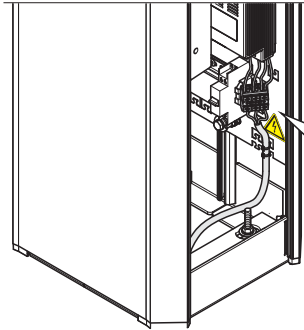
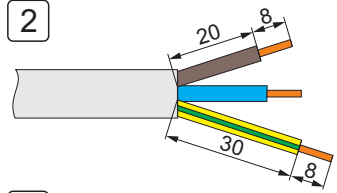

3

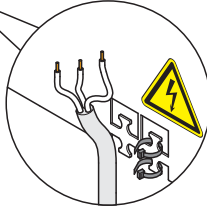

4

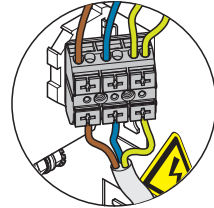

230 V AC / 50 – 60 Hz

Mag05005

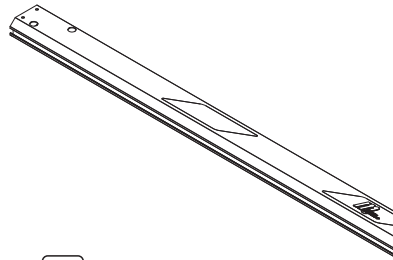
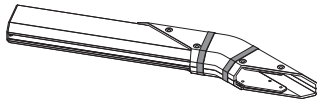

- 4 x M6 x 10 (T20)
- 8 x M6 x 12 (SW 4)
- 8 x M8

1

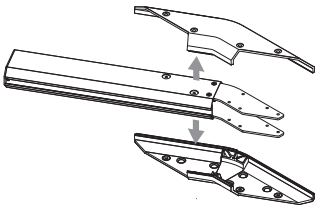

2

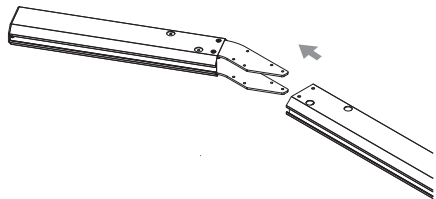

3

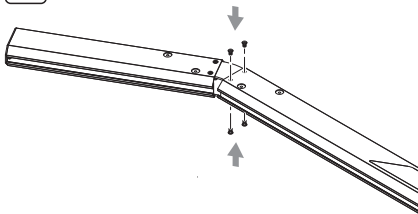

4

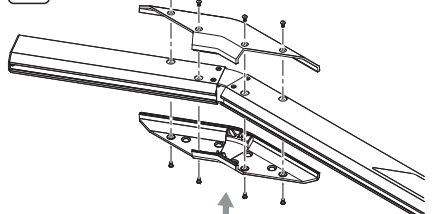

Mag05006a

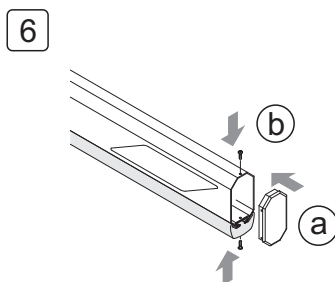
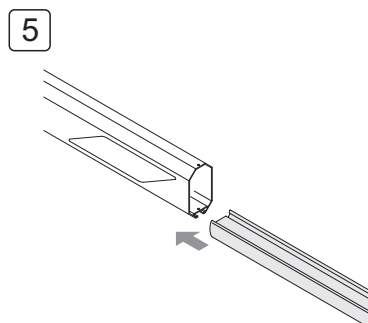
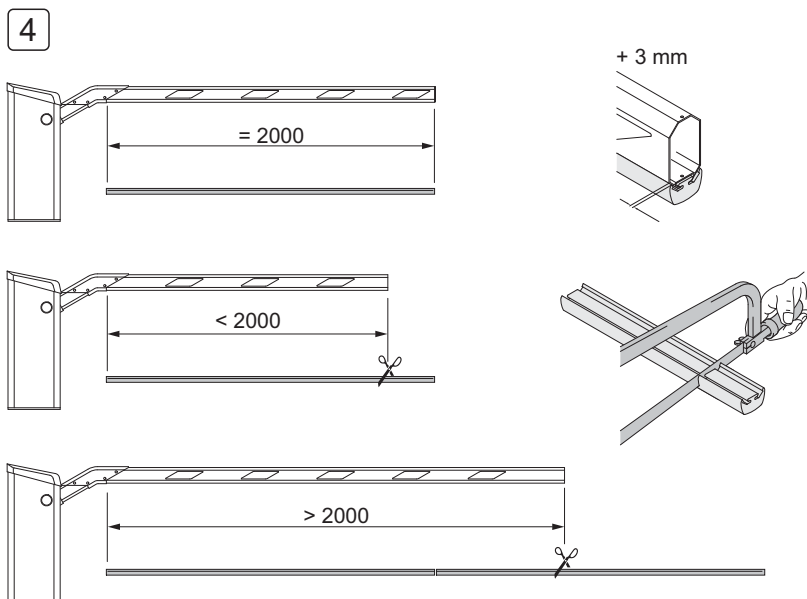
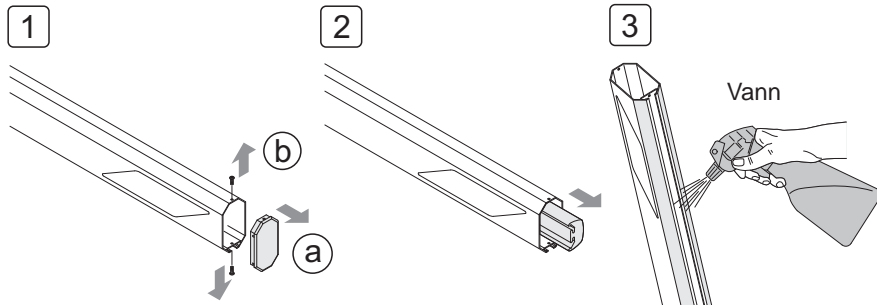

Mag05007a

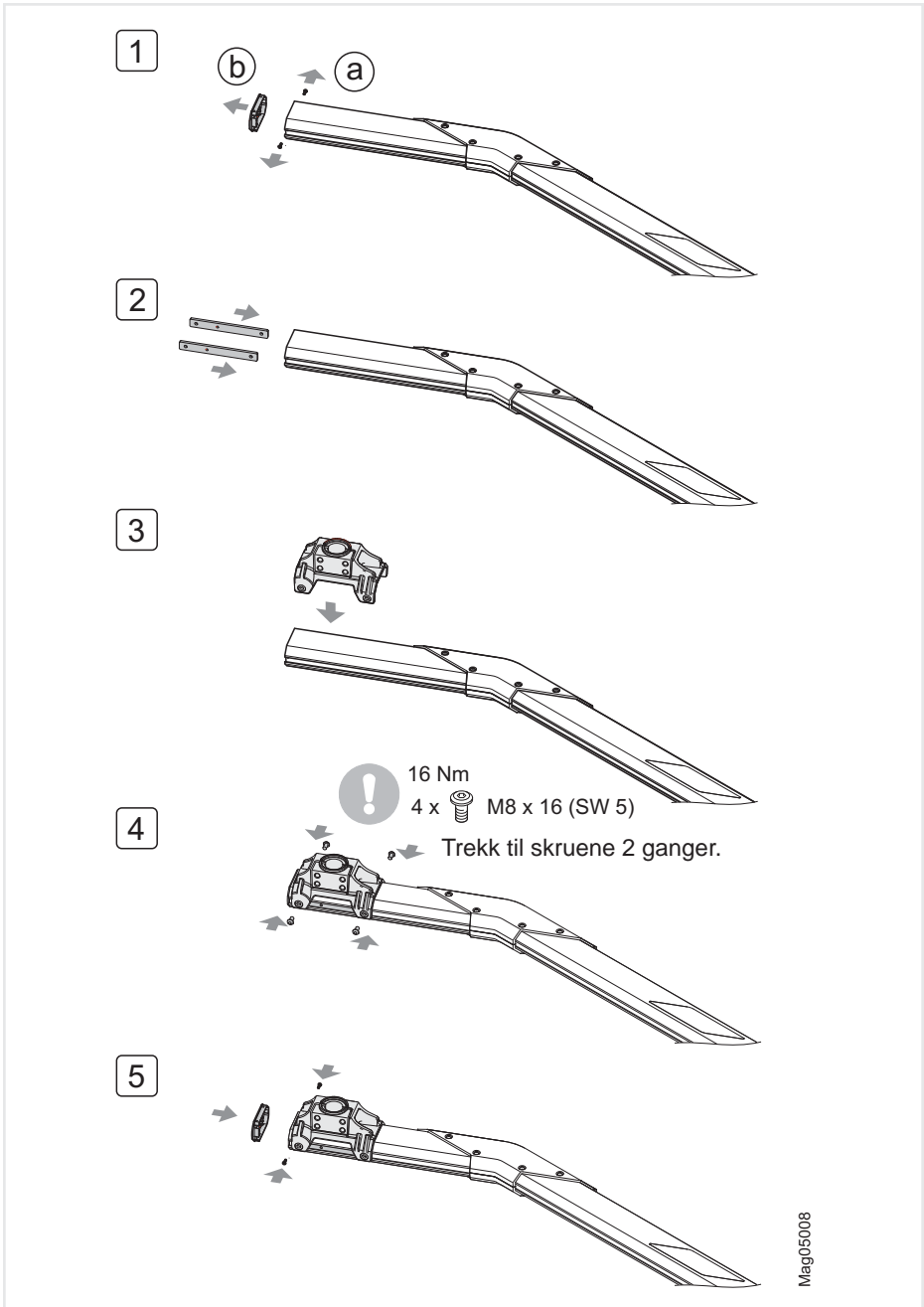

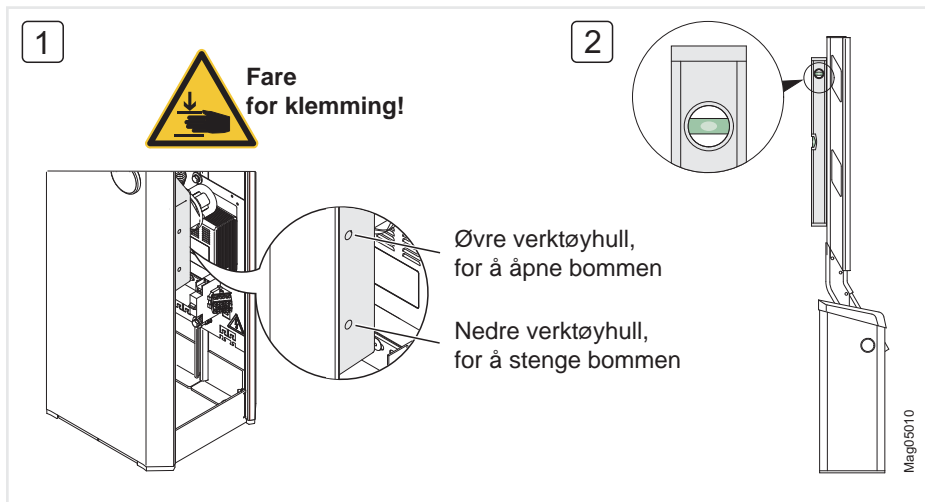
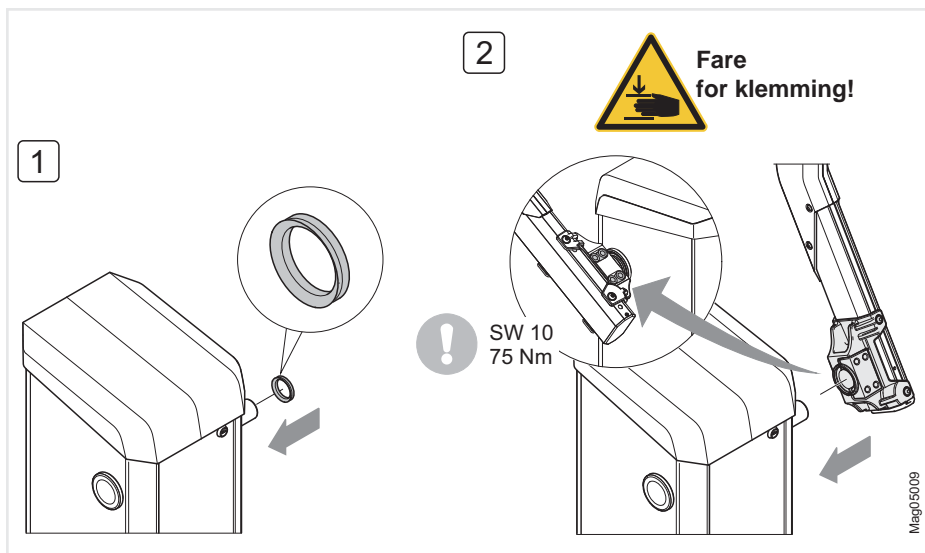

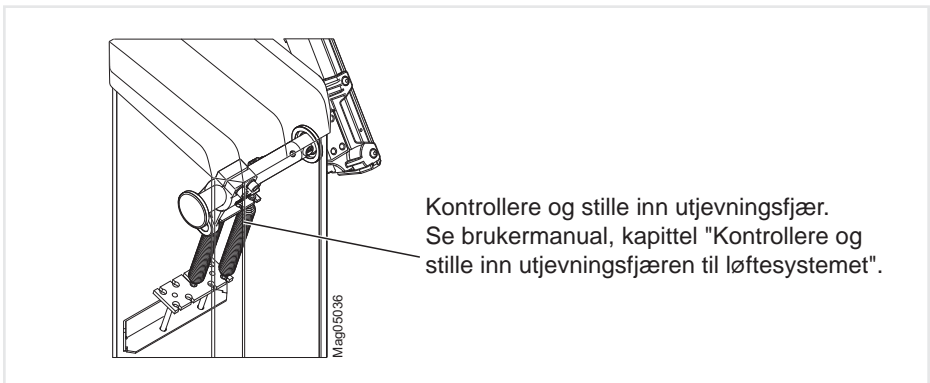
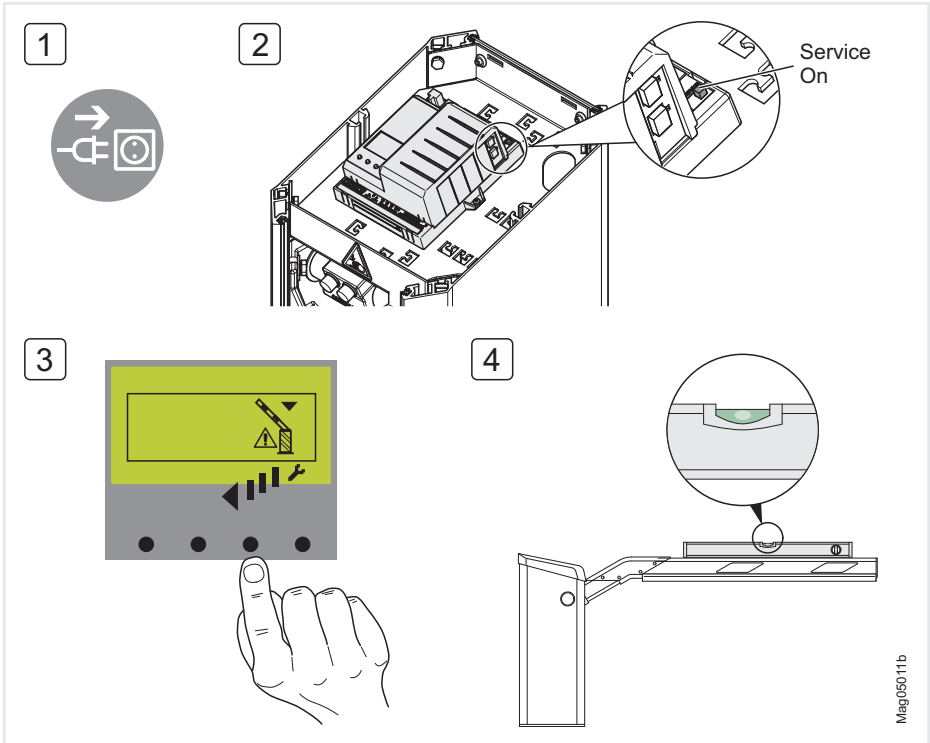

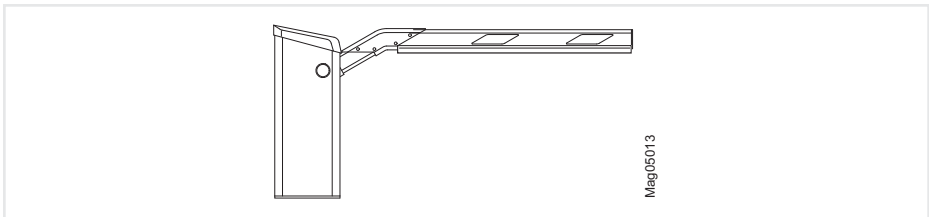
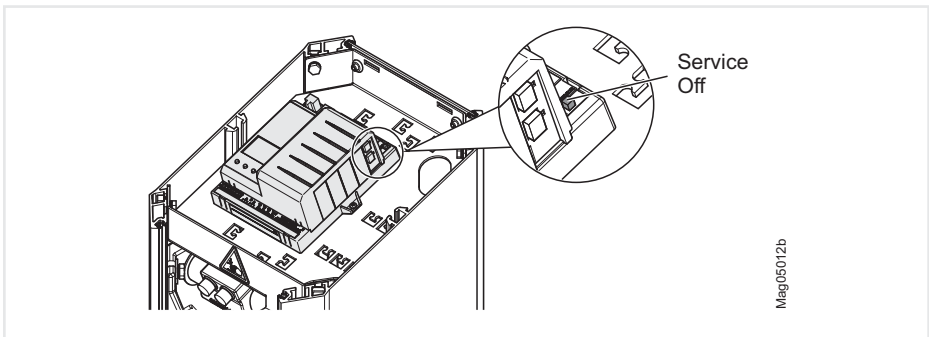
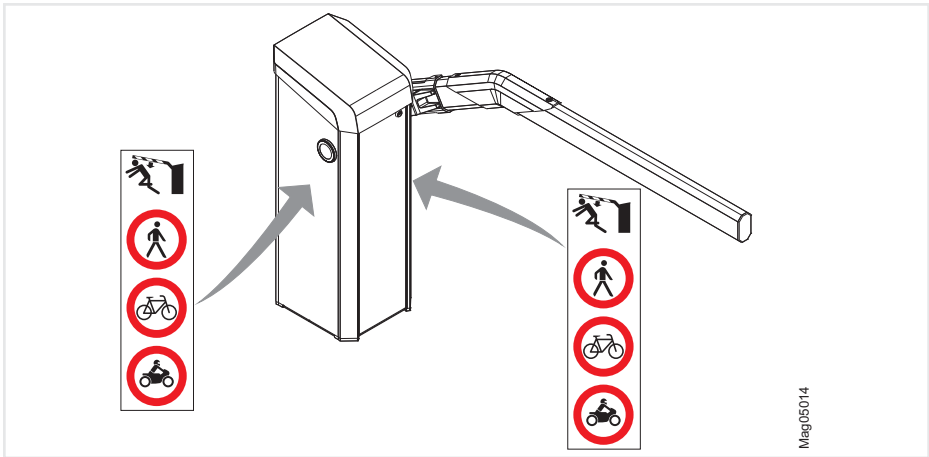

MAGNETIC Autocontrol GmbH

Grienmatt 20

79650 Schopfheim

Tyskland

Tlf.: +49 (0) 7622 695 5

Fax.: +49 (0) 7622 695 602

info@ac-magnetic.com

www.ac-magnetic.com